

Cypress Computer Systems, Inc. • 1778 Imlay City Rd. • Lapeer, MI 48446-3206
TX(810)245-2300 • FX(810)245-2332 • www.cypressworld.com

Cypress Synchronized 1 Inch LCD Clock



Product Description

General

The CCK-1401 1" LCD Synchronized Time Display is ideal for Time and Attendance applications where the Access Control System's time must be displayed. Up to 32 clocks can be driven from one time source over a single twisted pair network. Using the CCX-1550 Format Converter, the CCK-1401 interfaces with most manufacturers access control equipment.

CCK-1401

- Provides DIP switch selectable Cypress 1201 and 1101 Formats
- Adds time and day displays to Access Control and Time and Attendance Systems.
- Low profile facilitates mounting at reader location.
- Provides 12 or 24 hour time formats.
- Standard or Military (24 hour) Time Formats.

CCK-1401 Electrical Connections

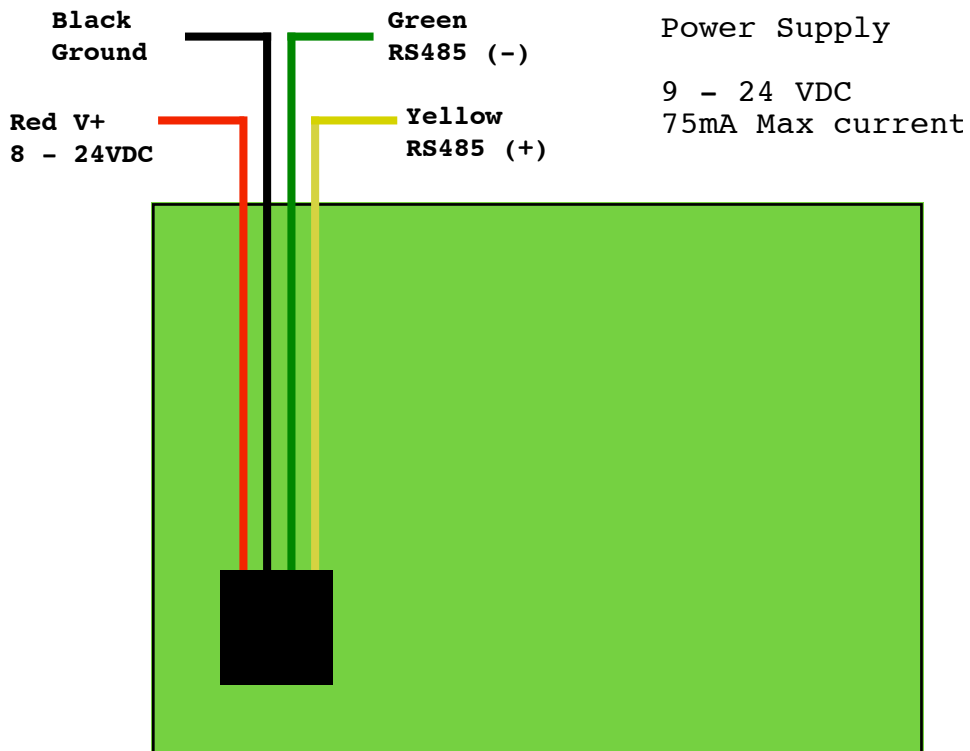
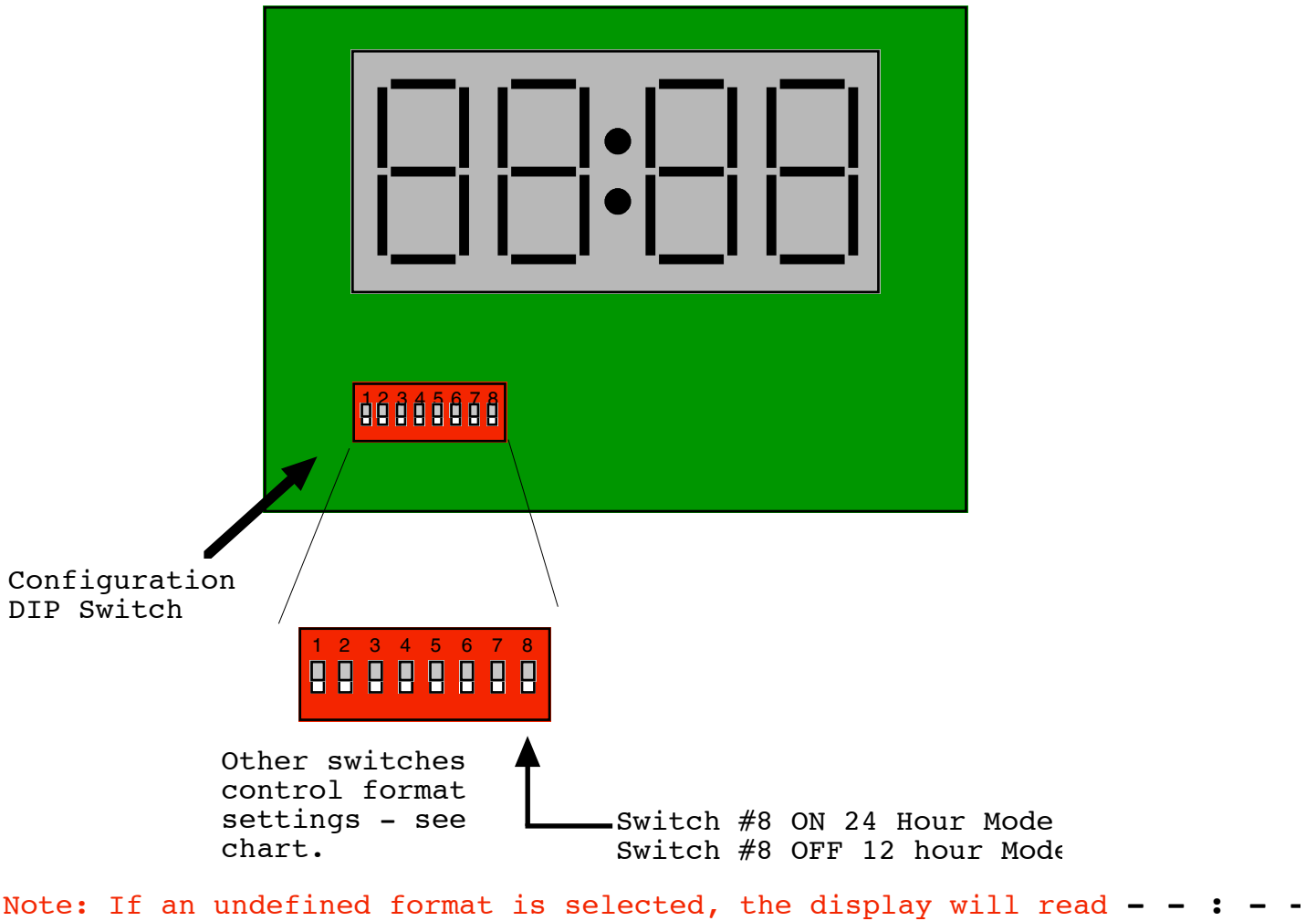

CCK-1401 Format Settings

#	DIP Switch Setting								Function
	1	2	3	4	5	6	7	8	
0									Test Mode
1	X								CCK-1101 Cypress Newtork Protocol
2		X							CCK-1201 Cypress Network Protocol
3	X	X							CCK-1201-M Mercury® Protocol 2
4			X						CCK-1201-M Mercury® Protocol 1
5	X		X						CCK-1201-M 2 Nexwatch® Protocol 2
6		X	X						CCK-1201-M2 Nexwatch® Protocol 1
7									
8									
9									
10									
11									
12									
13									
14									
15									
X = Switch On									

CCK-1401 Operational Description

CCK-1401 Time Displays: Functional Description

The clocks are used to display the time from a Master Time Source. When the Master Time Source sends a time stamp to the Clock Driver, the Clock Driver's internal time base is updated but the Master Time Source's time stamp is sent to the clocks. In other words, the Clock Driver's internal time base is updated but not used unless there is no master time stamp. Similarly, the clocks' internal time base is updated by time stamps from the Clock Driver but the actual Clock Driver time stamp is displayed. The Clock's internal time base is updated but not used unless there is a loss of Clock Driver information.

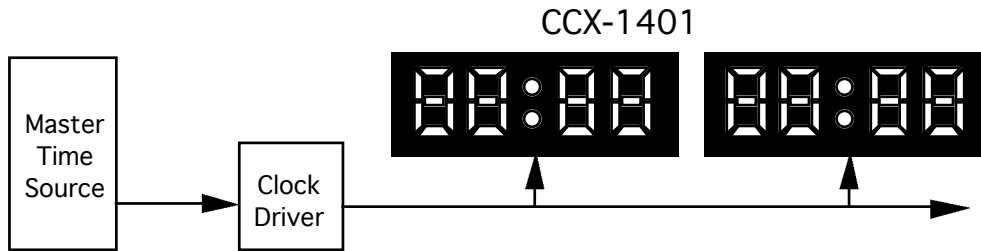

If there is a communication loss between the Master Time Source and the Clock Driver, the Clock Driver use its internal time base to update the clocks. A loss of communication is defined as 1 minute and 10 seconds without receiving a valid time stamp from the Master Time Source.

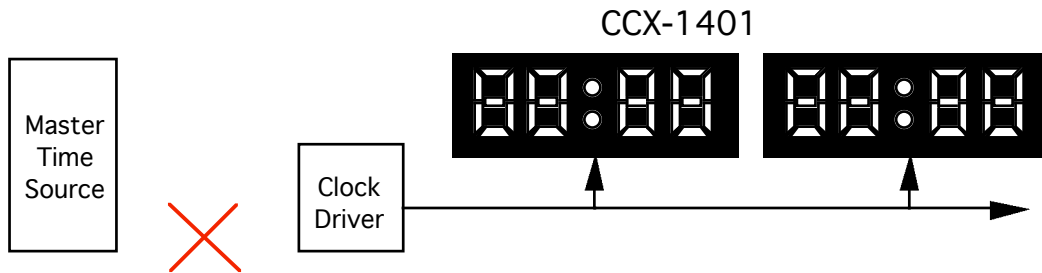

If the clocks lose contact with the Clock Driver, they use their internal time base to update the display. A loss of communication is defined as 5 seconds without receiving a valid time stamp.

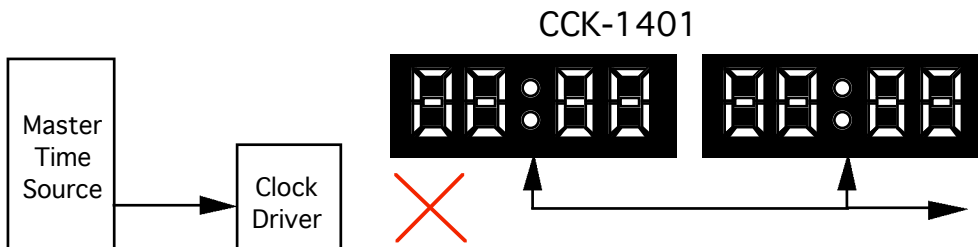

CCK-1401 System Level Wiring

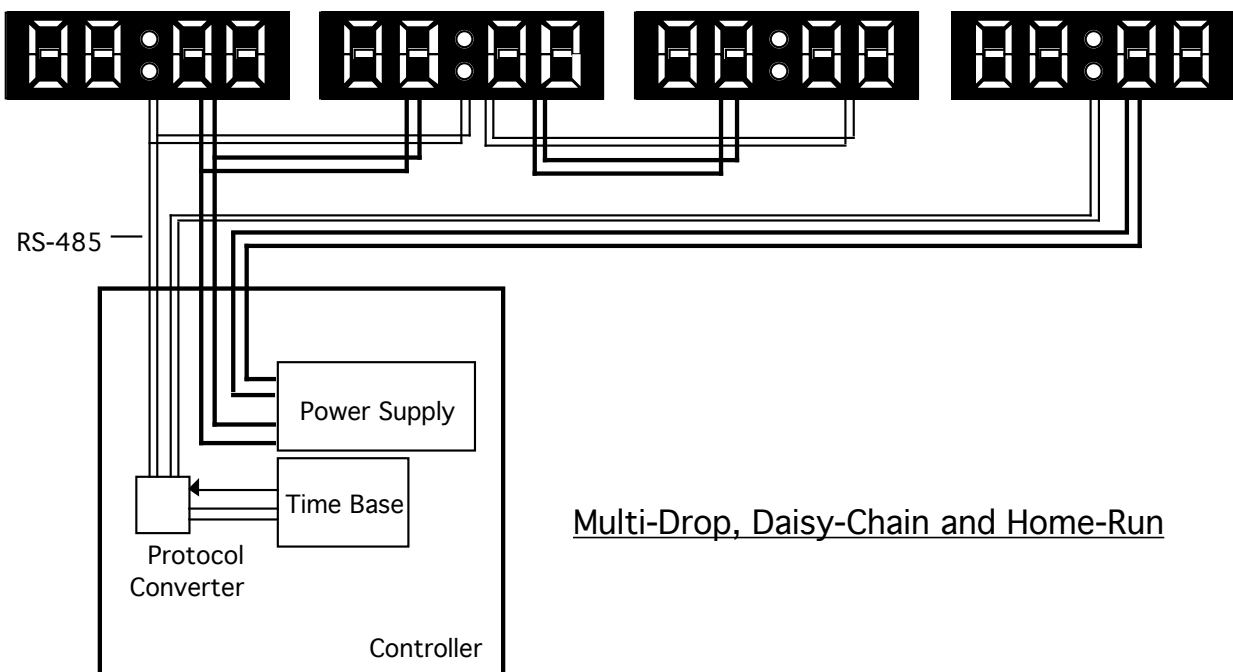
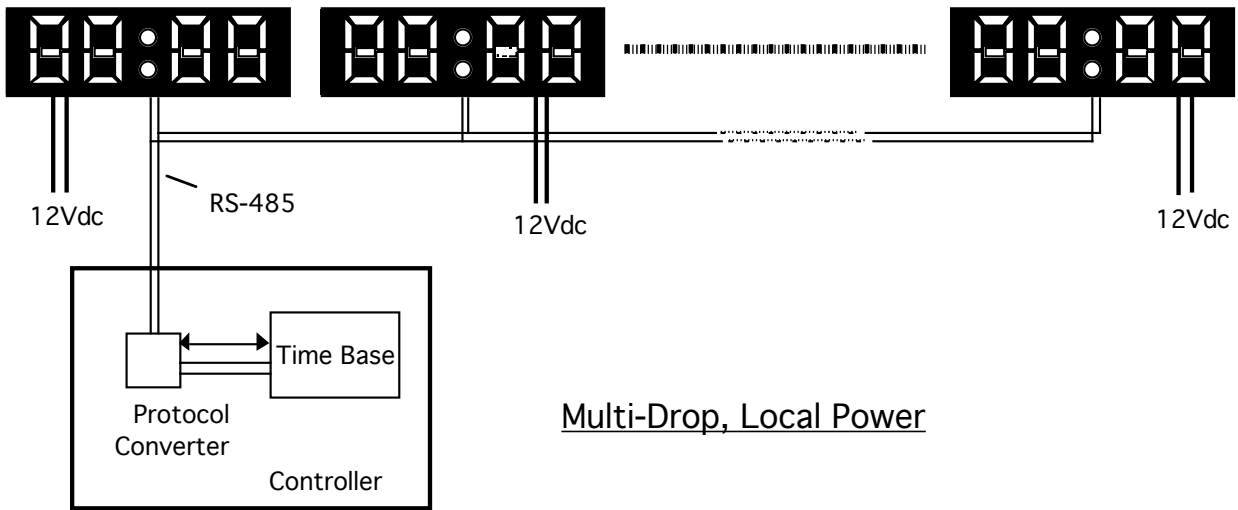
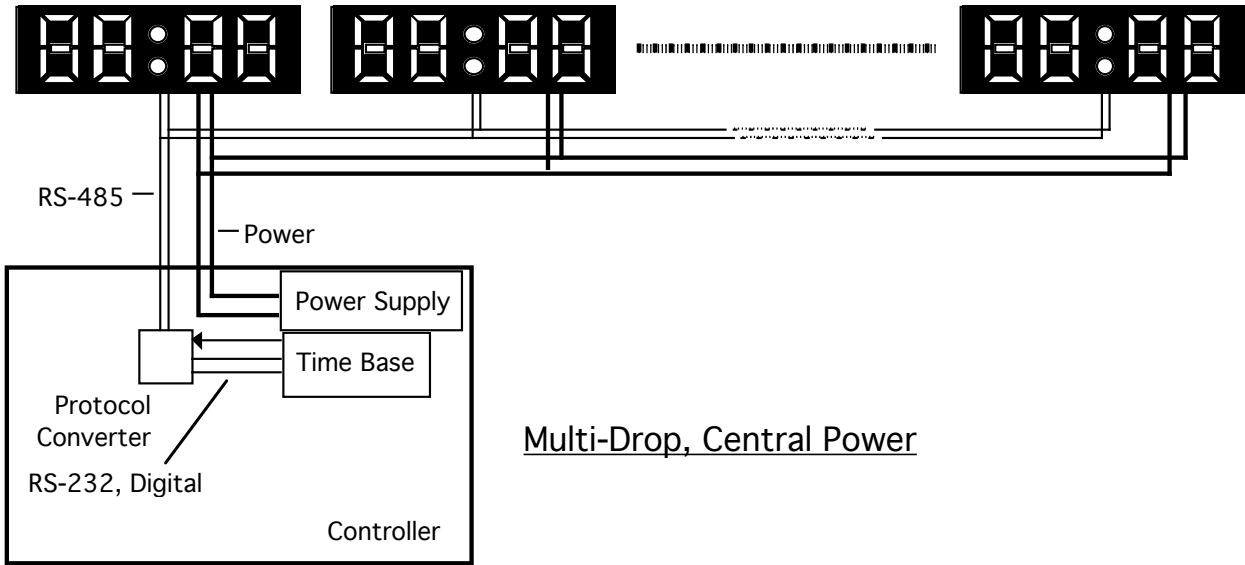

CCK-1401 Mounting Configuration

Mount enclosure to wall with electrical box (single gang)

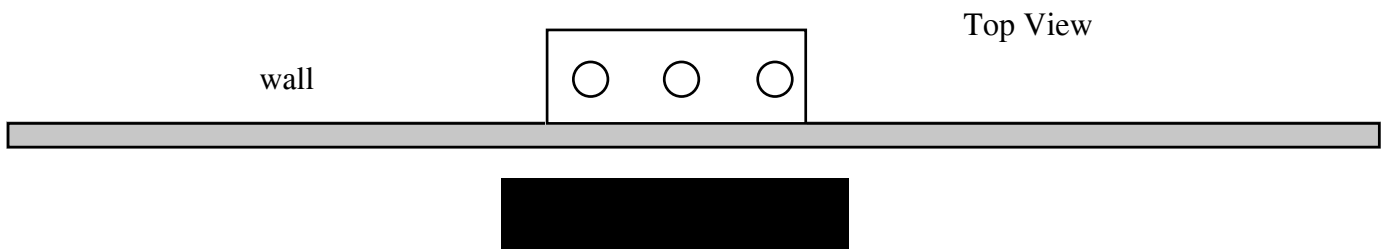
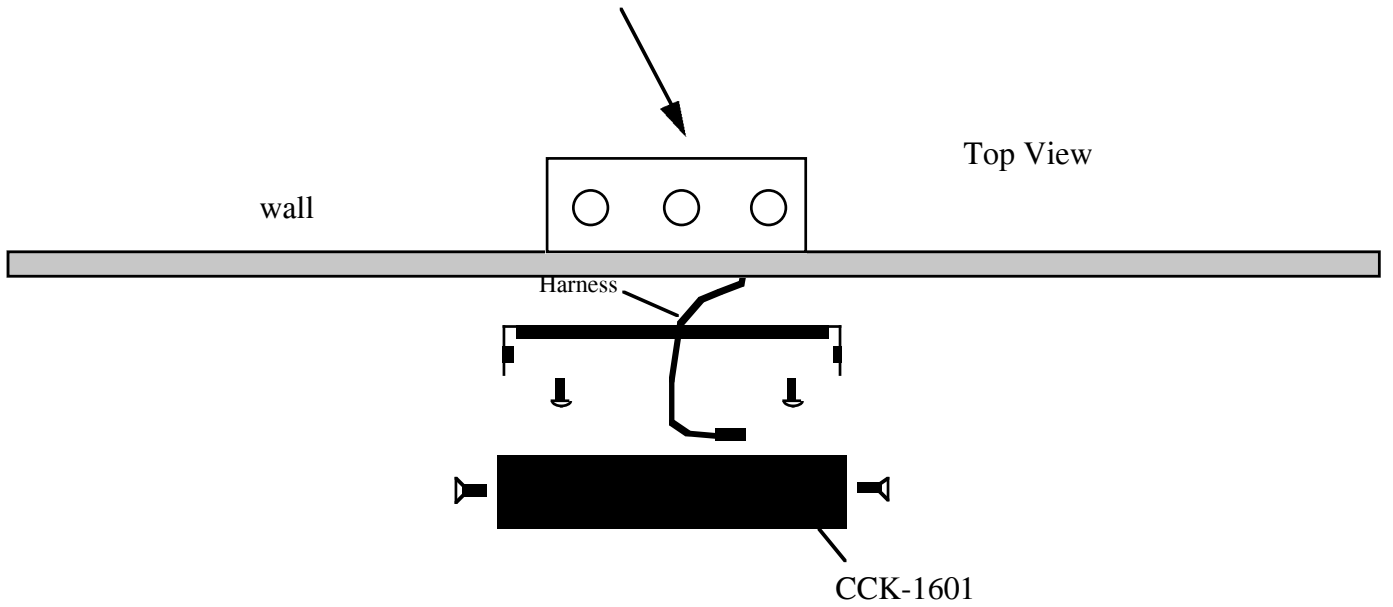

Wall Mounting

CCK-1401 Mounting Dimensions

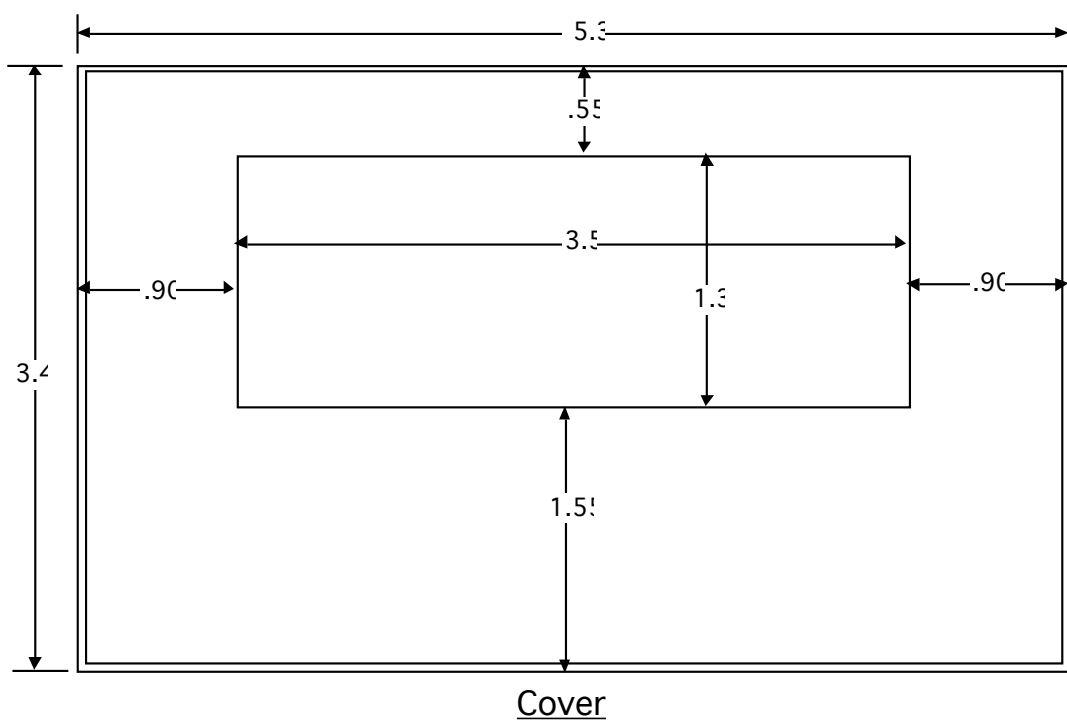
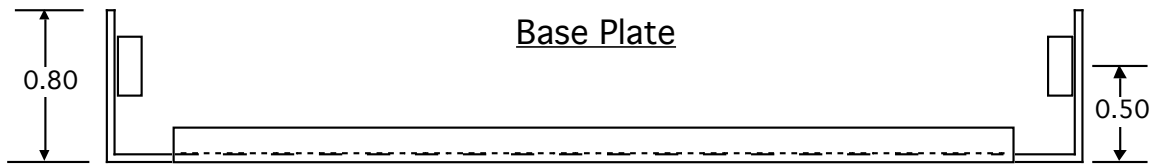
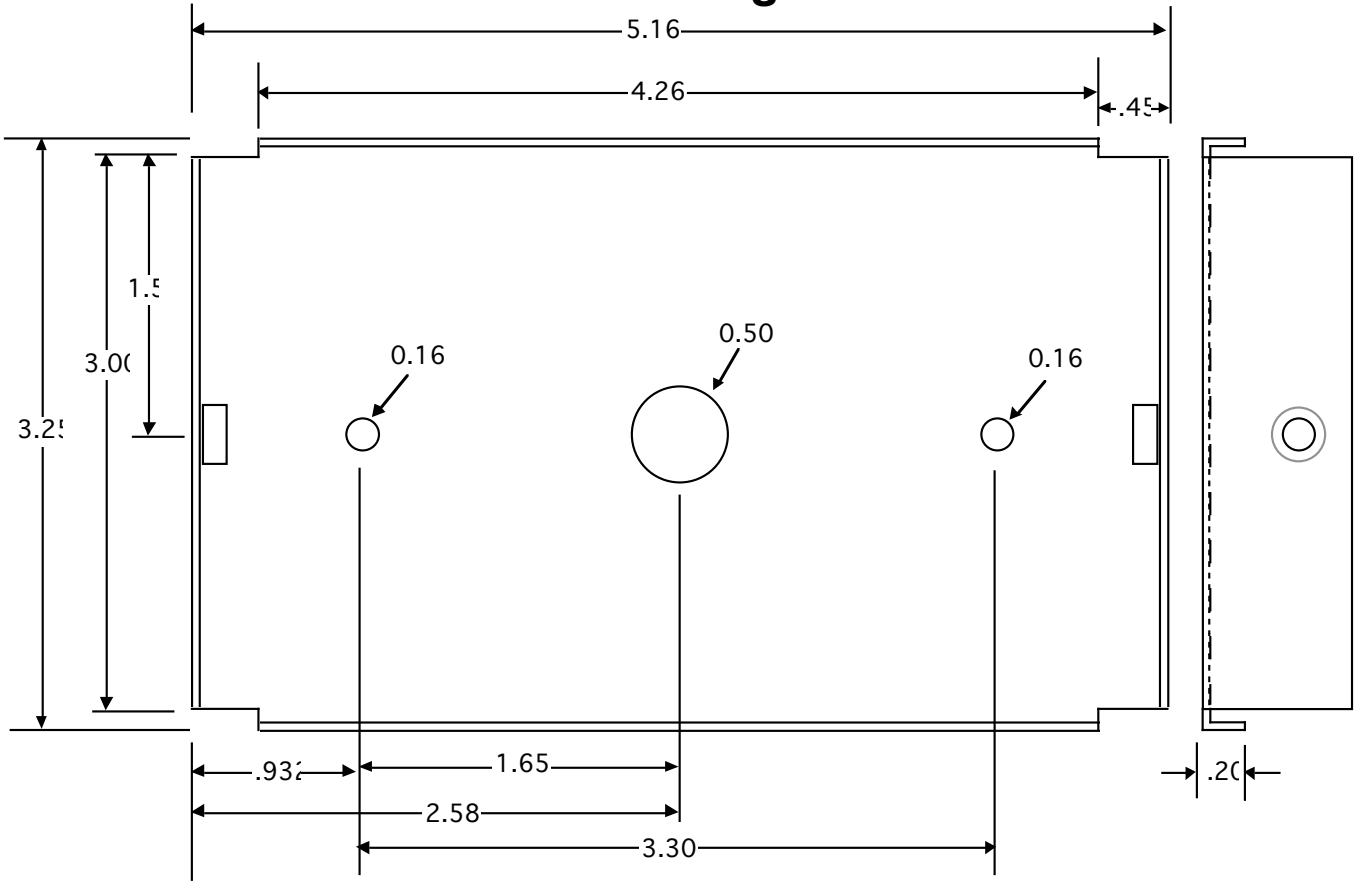

Cover

STATEMENT OF COMPLIANCE

This device complies with part 15 of the FCC Rules.

Operation is subject to the following two conditions:

- (1) This device may not cause harmful interference, and
- (2) this device must accept any interference received, including interference that may cause undesired operation.